

Flexible hose (For moderate and high pressure)

Dimensional drawing

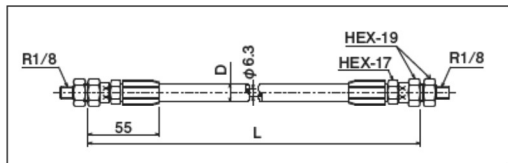

Model

For moderate pressure and high pressure (working temperature -40°C~+100°C)

Model	Part Number	Working pressure (MPa)	Minimum bending radius (R)	D (φ)	L (mm)
L1- 5	250151	10	85	13.5	500
L1- 7	250152				700
L1-10	250153				1000
L1-15	250154				1500
L3- 5	250161	35	105	15	500
L3- 7	250162				700
L3-10	250163				1000
L3-15	250164				1500

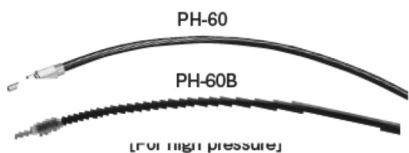
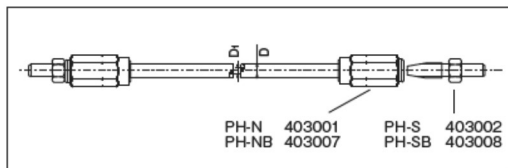

For high pressure (working temperature -30°C~+80°C)

Model	Part Number	D (φ)	D ₁ (φ)	Standard length	Working pressure (MPa)	Burst pressure (MPa)	Minimum bending radius (R)	Material	Color
PH-60	403010	8.3	3.6	100	20	72	15	Polyamide	Black
PH-60B	403020	12.37	6.35				40		

Directions for use

- Please make some allowance for length, bending radius and working pressure.

How to connections (PH-60)

Insert the hose into the hose sleeve. Then rotate counter-clockwise. Applying some oil on the hose surface will make it easier to handle. Stop when reaching the position 11mm away from the end. Then insert the hose stud by rotating clockwise until the hexagonal portion of the hose stud touches the hose sleeve.

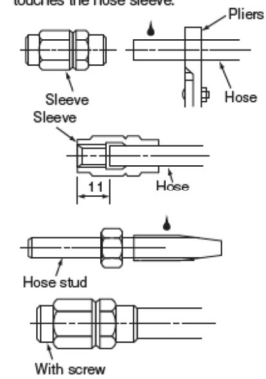

Dimensional drawing

● Hose sleeve

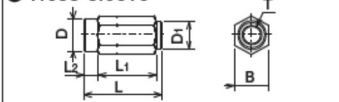

● Hose stud

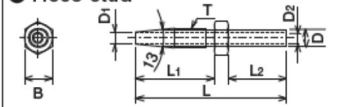

● Hose stud elbow

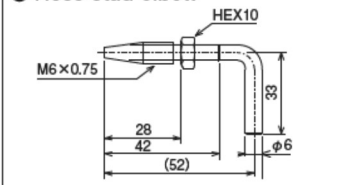

Model

Model	Part Number	T	L	L ₁	L ₂	D	D ₁	B
PH-N	403001	M6×0.75	28	21	5	φ11.7	φ10	12
PH-NB	403007	M9×1.0	37	31	4	φ16.5	φ14	17

●Material : Steel

Model	Part Number	T	L	L ₁	L ₂	D	D ₁	D ₂	B
PH-S	403002	M6×0.75	54	28	21	φ6	φ3.9	φ4	10
PH-SB	403008	M9×1.0	69	35.5	27	φ8	φ6.2	φ5	14

●Material : Steel

Model	Part Number
PH-SE	403003

●Material : Steel